

Insert

Dimensions (mm)

Process	Material Classification		Coated Carbide						Cemented Carbide	DLC	Cermet	Corner Radius RE	Fig		
	High-speed/Light	General-purpose	P	K	K	K	MS		N	P					
	High-speed/Light	General-purpose	P	K	K	K	MS	N	P						
	Roughing														
Cat. No.		ACU2500	XCU2500	ACP2000	ACP3000	XCK2000	ACK2000	ACK3000	ACM200	ACM300	H20	DL2000	T2500A		
AOMT	11T302PEER-G	●	●	●	●	●	●	●	●	●	—	—	●	0.2	1
	11T304PEER-G	●	●	●	●	●	●	●	●	●	—	—	●	0.4	1
	11T305PEER-G	●	●	●	●	●	●	●	●	●	—	—	●	0.5	1
	11T308PEER-G	●	●	●	●	●	●	●	●	●	—	—	●	0.8	1
	11T310PEER-G	●	●	●	●	●	●	●	●	●	—	—	●	1.0	1
	11T312PEER-G	●	●	●	●	●	●	●	●	●	—	—	●	1.2	1
	11T316PEER-G	●	●	●	●	●	●	●	●	●	—	—	●	1.6	1
	11T320PEER-G	●	●	●	●	●	●	●	●	●	—	—	●	2.0	1
	11T324PEER-G	●	●	●	●	●	●	●	●	●	—	—	●	2.4	1
	11T330PEER-G	●	●	●	●	●	●	●	●	●	—	—	●	3.0	2
	11T332PEER-G	●	●	●	●	●	●	●	●	●	—	—	●	3.2	2
AOMT	11T304PEER-H	●	●	●	●	●	●	●	●	●	—	—	—	0.4	1
	11T308PEER-H	●	●	●	●	●	●	●	●	●	—	—	—	0.8	1
	11T312PEER-H	●	●	●	●	●	●	●	●	●	—	—	—	1.2	1
	11T316PEER-H	●	●	●	●	●	●	●	●	●	—	—	—	1.6	1
AOET	11T302PEER-F	●	—	—	—	—	—	—	—	—	—	—	—	0.2	1
	11T304PEER-F	●	—	—	—	—	—	—	—	—	—	—	—	0.4	1
	11T305PEER-F	●	—	—	—	—	—	—	—	—	—	—	—	0.5	1
	11T308PEER-F	●	—	—	—	—	—	—	—	—	—	—	—	0.8	1
	11T310PEER-F	●	—	—	—	—	—	—	—	—	—	—	—	1.0	1
	11T312PEER-F	●	—	—	—	—	—	—	—	—	—	—	—	1.2	1
	11T316PEER-F	●	—	—	—	—	—	—	—	—	—	—	—	1.6	1
	11T320PEER-F	●	—	—	—	—	—	—	—	—	—	—	—	2.0	1
	11T324PEER-F	●	—	—	—	—	—	—	—	—	—	—	—	2.4	1
	11T330PEER-F	●	—	—	—	—	—	—	—	—	—	—	—	3.0	2
	11T332PEER-F	●	—	—	—	—	—	—	—	—	—	—	—	3.2	2
AOET	11T302PEER-P16	●	—	—	—	—	—	—	—	—	—	—	—	0.2	1
	11T304PEER-P16	●	—	—	—	—	—	—	—	—	—	—	—	0.4	1
	11T305PEER-P16	●	—	—	—	—	—	—	—	—	—	—	—	0.5	1
	11T308PEER-P16	●	—	—	—	—	—	—	—	—	—	—	—	0.8	1
	11T310PEER-P16	●	—	—	—	—	—	—	—	—	—	—	—	1.0	1
	11T312PEER-P16	●	—	—	—	—	—	—	—	—	—	—	—	1.2	1
AOET	11T302PEER-P20	●	—	—	—	—	—	—	—	—	—	—	—	0.2	1
	11T304PEER-P20	●	—	—	—	—	—	—	—	—	—	—	—	0.4	1
	11T305PEER-P20	●	—	—	—	—	—	—	—	—	—	—	—	0.5	1
	11T308PEER-P20	●	—	—	—	—	—	—	—	—	—	—	—	0.8	1
	11T310PEER-P20	●	—	—	—	—	—	—	—	—	—	—	—	1.0	1
	11T312PEER-P20	●	—	—	—	—	—	—	—	—	—	—	—	1.2	1
AOET	11T302PEER-P25	●	—	—	—	—	—	—	—	—	—	—	—	0.2	1
	11T304PEER-P25	●	—	—	—	—	—	—	—	—	—	—	—	0.4	1
	11T305PEER-P25	●	—	—	—	—	—	—	—	—	—	—	—	0.5	1
	11T308PEER-P25	●	—	—	—	—	—	—	—	—	—	—	—	0.8	1
	11T310PEER-P25	●	—	—	—	—	—	—	—	—	—	—	—	1.0	1
	11T312PEER-P25	●	—	—	—	—	—	—	—	—	—	—	—	1.2	1
AOET	11T302PEFR-S	—	—	—	—	—	—	—	—	—	●	●	—	0.2	1
	11T304PEFR-S	—	—	—	—	—	—	—	—	—	●	●	—	0.4	1
	11T305PEFR-S	—	—	—	—	—	—	—	—	—	●	●	—	0.5	1
	11T308PEFR-S	—	—	—	—	—	—	—	—	—	●	●	—	0.8	1
	11T310PEFR-S	—	—	—	—	—	—	—	—	—	●	●	—	1.0	1
	11T312PEFR-S	—	—	—	—	—	—	—	—	—	●	●	—	1.2	1
	11T316PEFR-S	—	—	—	—	—	—	—	—	—	●	●	—	1.6	1
	11T320PEFR-S	—	—	—	—	—	—	—	—	—	●	●	—	2.0	1
	11T324PEFR-S	—	—	—	—	—	—	—	—	—	●	●	—	2.4	1
	11T330PEFR-S	—	—	—	—	—	—	—	—	—	●	●	—	3.0	2
	11T332PEFR-S	—	—	—	—	—	—	—	—	—	●	●	—	3.2	2

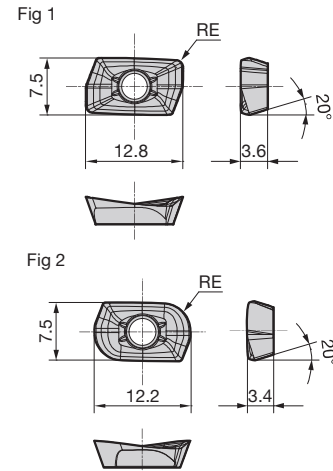

-G: General-purpose, -H: Strong Edge, -F: Medium Finishing, -P16/-P20/-P25: High-precision Machining, -S: Non-Ferrous Metals.

Precautions for Mounting Inserts Recommended Cutting Conditions

* -P16 is applicable to cutter diameters $\phi 14$ and $\phi 16$. -P20 is applicable to cutter diameters $\phi 18$ and $\phi 20$. -P25 is applicable to cutter diameters $\phi 25$ and $\phi 28$.

● mark: Standard stocked item ● mark: Standard stocked item (expanded item) Blank: Made-to-order item — mark: Not available

WEZ
 WEZR
 Shell
 Shank
 Modular
 Application Examples
 Made-to-Order Product